

# EHPWH Fan Motor

## REPLACEMENT INSTRUCTIONS

Kit Name	Fan Motor Kit
Kit Part Number	108000140
Compatible Rinnai Products	Rinnai Heat Pump Water Heater: All REHP Series Models

**WARNING** Failure to correctly assemble the components according to these instructions may result in electric shock, injury, or death.

### CAUTION

To protect yourself from harm, follow the steps below before proceeding.

- Antistatic gloves must be worn.
- Disconnect the electrical power supply by turning off the electricity at the circuit breaker.
- Turn off the water by closing manual ball valves for the hot and cold water connections at the appliance.

## Items Inside Product Box

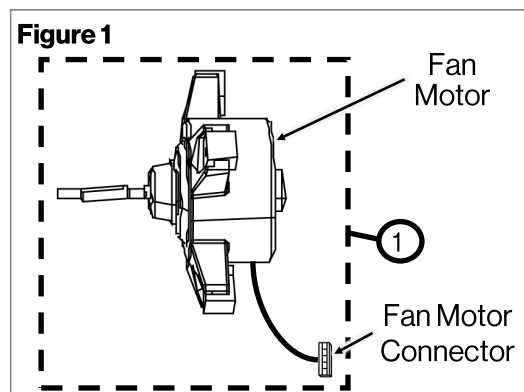
Before installation, please make sure all parts are located inside the product box.

Table 1

Item #	Item	Qty
1	Fan Motor with Connector	1

### TOOLS/MATERIALS REQUIRED

- Phillips Head Screw Driver
- Flat Head Screw Driver
- Adjustable Wrench
- Tongue and Groove Plier



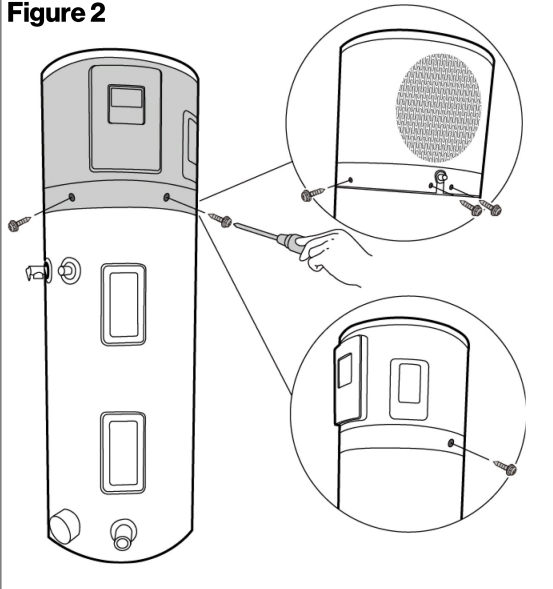
## Instructions

1. Antistatic gloves must be worn to protect yourself from harm.
2. Disconnect the electrical power supply by turning off the electricity at the circuit breaker.
3. Turn off the water by closing manual valves for the hot and cold water connections at the appliance.
4. Use a Phillips head screw driver to remove 6 screws located around the appliance securing top cover to the appliance (Figure 2). Keep the removed 6 screws to be reinstalled in step 31.
5. Use a flat head screw driver to remove the display box front cover. To remove, slide the flat head of screw driver into the slots located on the bottom side of cover and twist the driver to remove (Figure 3). Keep front cover safe to be reinstalled in step 30.

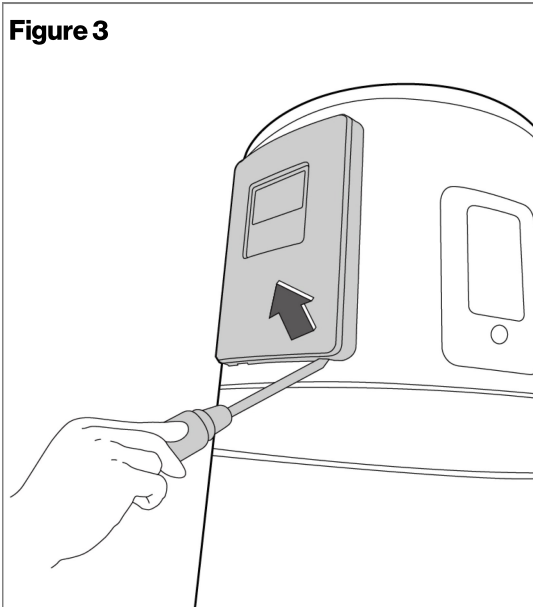
### IMPORTANT

When following the instructions to remove display box front cover, ensure not to apply unnecessary force. If applied, it may break the snap pins located on the display front cover and prevent it from assembling it back. Ensure to twist the screw driver softly and the cover should open without any damage.

**Figure 2**



**Figure 3**

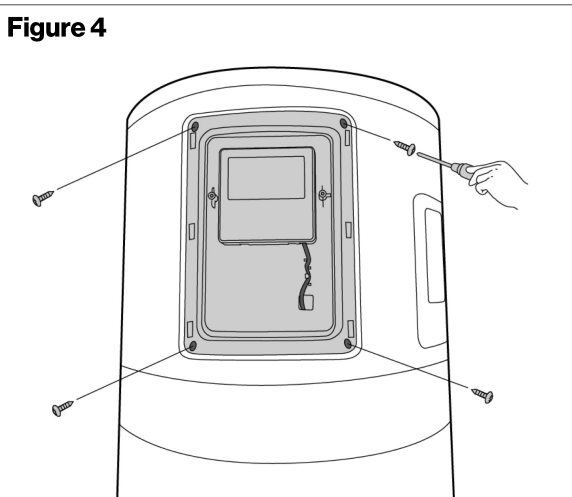


6. Use a Phillips head screw driver to remove 4 screws securing the display box rear cover (Figure 4). Keep removed 4 screws safe to be reinstalled in step 29.
7. Use a flat head screw driver to remove the display box. To remove, slide the flat head of screw driver into the slots located on the bottom side of box and twist the driver to remove (Figure 5).

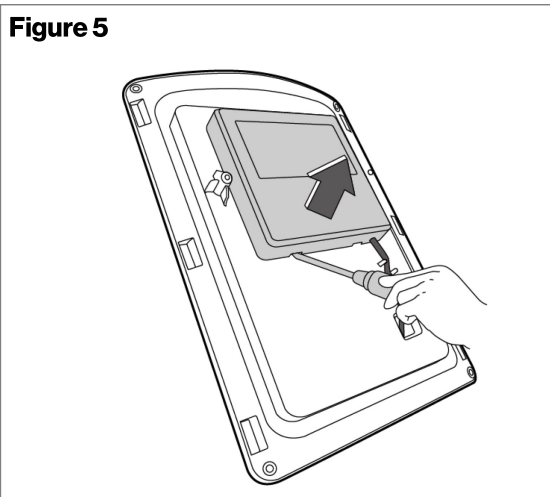
**IMPORTANT**

When following the instructions to remove display box, ensure not to apply unnecessary force. If applied, it may break the snap pins located on the display box and prevent it from assembling it back. Ensure to twist the screw driver softly and the box should open without any damage.

**Figure 4**

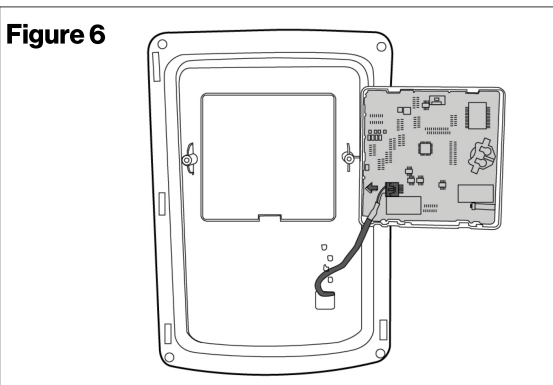


**Figure 5**

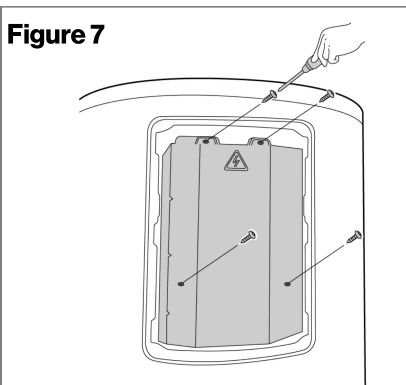


8. Disconnect the display board connector (Figure 6). Keep display box and display board safe to be reinstalled in step 27 & step 28.
9. Use a Phillips head screw driver to remove 4 screws securing the cover of main control E-box (Figure 7). The cover contains two items, the sheet metal piece supported with the plastic cover, ensure to remove both. Keep the cover safe to reinstalled in step 26.

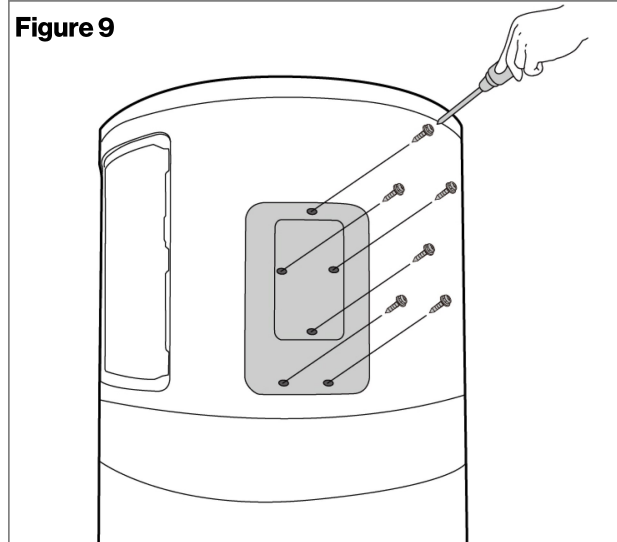
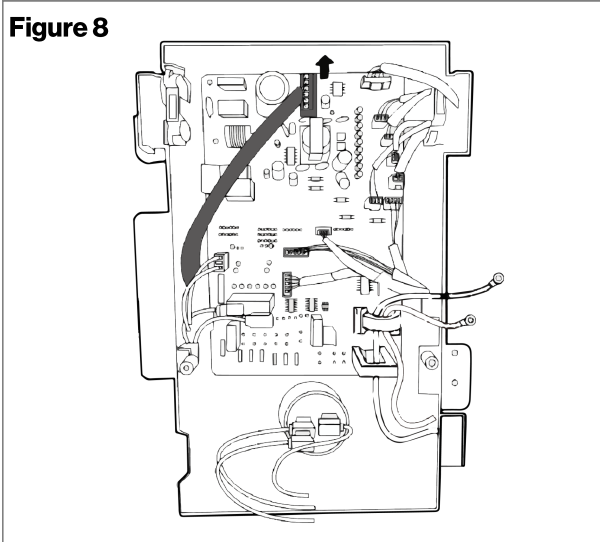
**Figure 6**



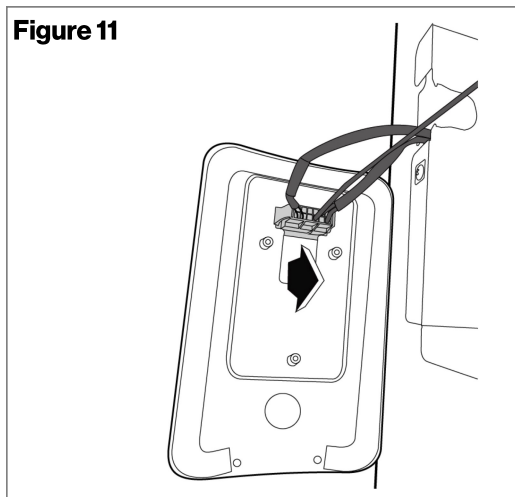
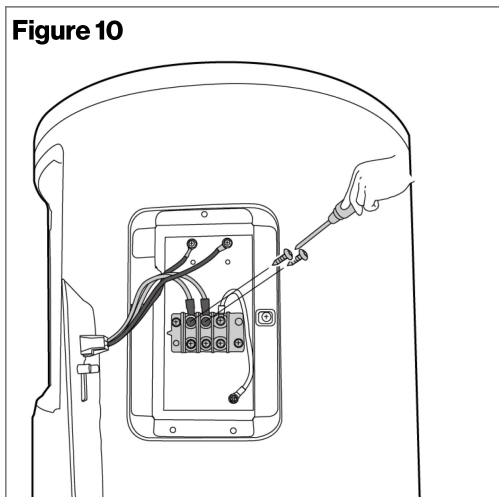
**Figure 7**



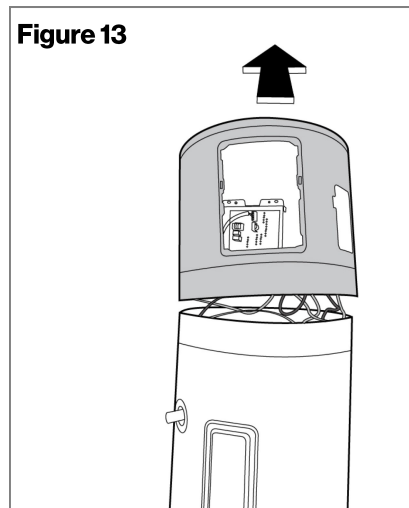
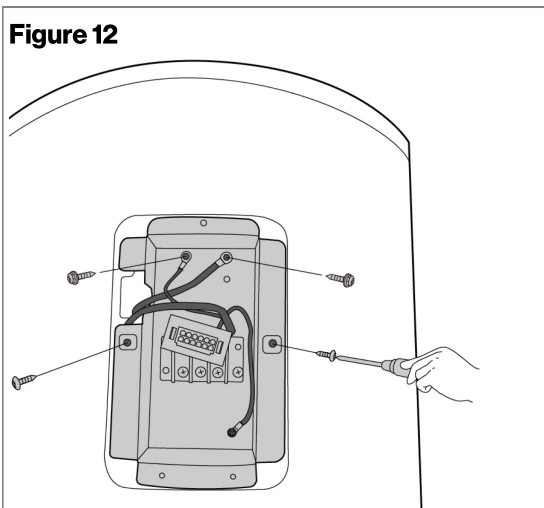
10. Disconnect fan motor cable from CN51 connector on the main control board (Figure 8). Ensure to remove retention clip before disconnecting the connector from the board. Keep the retention pin safe to be reinstalled in step 25.
11. Use a Phillips head screw driver to remove 6 screws securing the junction box cover and CTA 2045 cover (Figure 9). Keep these 6 screws safe to be reused in step 24.



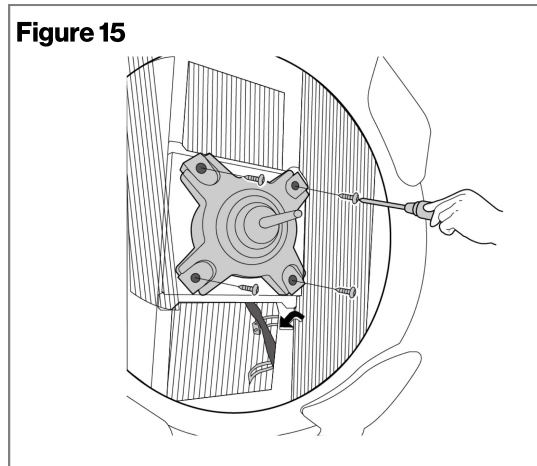
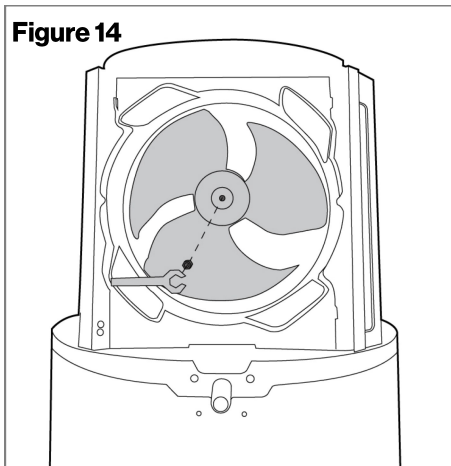
12. Use a Phillips head screw driver to remove 2 screws and release line L1 (black) and line L2 (white) (Figure 10). Disconnect power supply cable on the breaker side too if needed. Keep removed 2 screws safe to be reinstalled in step 23.
13. Remove CTA2045 connector from the junction box cover (Figure 11). Keep junction box cover and CTA2045 cover secured to be reused in step 22.



14. Use a Phillips head screw driver to remove 2 grounding screws and 2 screws securing junction box to the appliance (Figure 12). Keep the junction box safe to be reinstalled in step 21.
15. Slide the top cover upwards to remove (Figure 13). Keep the top cover safe to be reinstalled in step 20.



16. Locate the fan on the appliance and remove a nut securing the fan using adjustable wrench (Figure 14). Take out the fan and keep it safe to be reinstalled in step 19.
17. Use a Phillips head screw driver to remove 4 screws securing fan motor to the appliance (Figure 15). Loosen up the metal strips holding the connector cable and pull out fan motor with a connector.



## Fan Motor Reassembly

18. Install new fan motor using 4 screws on the appliance (Figure 15). Secure the new cable with metal strips and bring the connector close to main control board.
19. Reinstall fan on new fan motor using a nut (Figure 14).
20. Slide back the top cover on the appliance (Figure 13). Ensure to align the top cover to the appliance correctly so the cavity of the main control board on the top cover lines up with the main control board.
21. Reinstall grounding cables and junction box on the appliance using 4 screws (Figure 12).
22. Snap back the CTA-2045 connector on the junction box cover (Figure 11).
23. Mount back power supply cables using 2 screws as shown in Figure 10.
24. Reinstall junction box cover and CTA 2045 cover using 6 screws (Figure 9).
25. Connect the new fan motor connector to CN51 connector on the main control board (Figure 8). Ensure to install back retention pin.
26. Reinstall the cover of main control E-box using 4 screws (Figure 7).
27. Reconnect the display board connector (Figure 6).
28. Install back the display board on the display box rear cover (Figure 5).
29. Reinstall display box rear cover on the appliance using 4 screws (Figure 4).
30. Install back display box front cover on top of display box rear cover (Figure 3).
31. Secure top cover to the appliance using 6 screws (Figure 2).
32. Turn on the water by opening manual valves for the hot and cold water connections at the appliance.
33. Reconnect the electrical power supply by turning on the electricity at the circuit breaker.
34. Ensure that the appliance runs fine. May need to open one of the faucets in the house to fire up the appliance.

800000227  
3/2024